

RADI-LUGS copper crimp lugs are made from 99.9 % pure high conductivity copper, which provide the best electrical properties in its grade. The heavy wall thickness in the barrel provides good termination and excellent electrical and mechanical properties.

The lugs come either with /without inspection hole. Barrel entry is chamfered to facilitate easy and smooth cable entry.

The product can withstand an operating temperature ranging from -55°C to +155°C, which is well above the normal operating temperature. For operating temperature above 155°C to 350°C we have nickel-plated lugs.

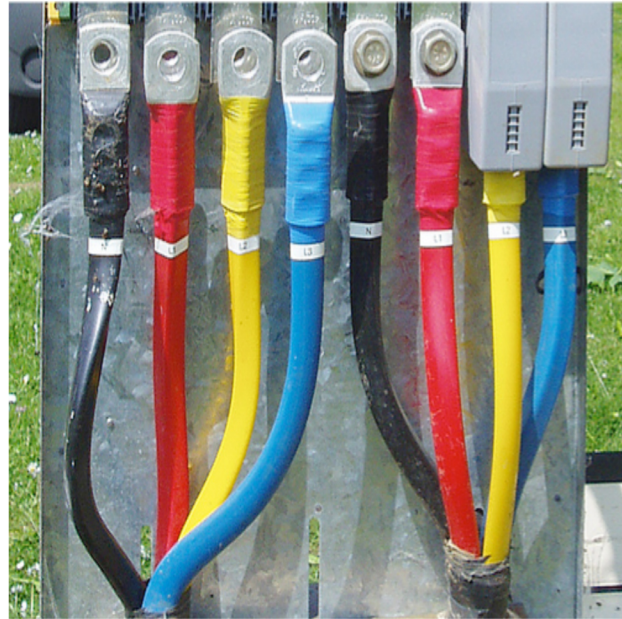

General Properties

Operating temperature:

Electro-tin plated: -55 to 150 deg C

Electro-nickel plated: -55 to 350 deg C

Total Conductivity: max @99.25 % IACS (approx.)

Total resistivity: 0.0172 ohms/mm²

Copper Material

Copper Purity: 99.90%

Oxygen content: 30 p,pm

Tensile strength: 23kg/mm²

Ductile rating: 40%

Final metal state: Fully annealed

Electroplating material conform to BS1872 (1984)

Tin material: 99%

Other materials: Lead and antimony

Thickness: 5 to 10 micron

Product overall performance and specification

conform to: BS 4579-2-1973

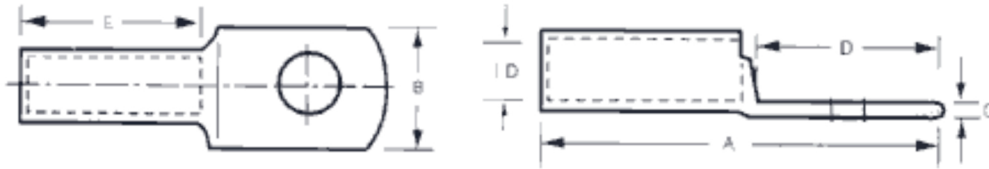

Above info act as a guide, for detailed technical spec, please check with the product technical datasheet

PRODUCT DIMENSIONS

Part Number	Cable Size (mmsq)	Stud Hole	Internal Dia. (mm)	Outer Dia. (mm)	A	B	C	D	E
RADI 1.5-5	1.5	M5	1.8	3.7	16	8	1.0	9	5
RADI 1.5-6	1.5	M6	1.8	3.7	18	10	0.8	9	5
RADI 2.5-4	2.5	M4	2.4	4.0	18	8	1.0	9	7
RADI 2.5-5/6	2.5	M5, M6	2.4	4.0	20	10	0.8	11	7
RADI 4-5/6	4.0	M5, M6	3.1	4.8	20	10	1.0	11	7
RADI 6-5	6.0	M5	3.8	5.5	23	10	1.2	11	9
RADI 6-6/8	6.0	M6, M8	3.8	5.5	27	12	1.0	15	9
RADI 10-6	10.0	M6	4.5	6.2	25	12	1.2	13	9
RADI 10-9	10.0	M8	4.5	6.2	27	12	1.2	15	9
RADI 16-6	16.0	M6	5.4	7.1	30	12	1.4	14	12
RADI 16-8/10	16.0	M8, M10	5.4	7.1	32	12	1.4	16	12
RADI 20-8	20.0	M8	6.0	7.7	32	12	1.6	16	12
RADI 25-6	25.0	M6	6.8	8.8	30	13	2.0	14	12
RADI 25-8/10/12	25.0	M8, M10, M12	6.8	8.8	37	17	1.3	21	12
RADI 35-6/8	35.0	M6, M8	8.2	10.6	35	15	2.4	18	12
RADI 35-10/12	35.0	M10, M12	8.2	10.6	38	18	1.9	21	12
RADI 50-8/10/12	50.0	M8, M10, M12	9.5	12.4	43	18	2.9	21	16
RADI 70-8/10/12	70.0	M8, M10, M12	11.2	14.7	50	21	3.5	25	18
RADI 70-16	70.0	M16	11.2	14.7	51	21	3.5	25	18
RADI 95-10/12/16	95.0	M10, M12, M16	13.5	17.4	55	25	3.9	26	20
RADI 120-10/12	120.0	M10, M12	15.0	19.4	60	28	4.4	28	22
RADI 120-16	120.0	M16	15.0	19.4	64	28	4.4	28	22
RADI 150-12/16	150.0	M12, M16	16.5	21.2	69	30	4.7	32	26
RADI 185-12/16	185.0	M12, M16	18.5	23.5	78	34	5.0	34	32
RADI 240-12/16/20	240.0	M12, M16, M20	21.0	26.5	92	38	5.5	40	38
RADI 300-12/16/20	300.0	M12, M16, M20	23.5	30.0	101	43	6.5	44	42
RADI 400-12/16/20	400.0	M12, M16, M20	26.8	34.8	114	50	8.0	53	44
RADI 500-16/20	500.0	M16, M20	30.0	39.0	124	56	9.0	56	48
RADI 630-16/20	630.0	M16, M20	35.0	45.0	144	65	10.0	66	56
RADI 800-BLK	800.0	BLANK	39.0	50.6	170	73	11.6	72	78
RADI 000-BLK	1000.0	BLANK	43.0	56.0	200	81	13.2	89	90

* The above dimensions chart is for your information and reference. The products' dimensions are designed to meet BS 4579-2-1973 specification. Other dimensions and designs are available upon request. If you have special requirements, please do not hesitate to contact our technical offices or representatives in your local area.

The above products' dimensions are for reference and information. The manufacturer reserves the rights to make changes to the products' dimensions as they see fit, without prior notice. Please check with our technical office or your local distributors when in doubts.